

Technical data sheet

Threaded sleeve for heavy-duty frame cassette

Item number: 7406861



Threaded sleeves for retro-installation in heavy-duty frame cassettes.



A2 Stainless steel

Master data

Item number	7406861
Type	GH RK SL30
Description 1	Threaded sleeve
Description 2	for heavy-duty frame cassette
Manufacturer	OBO
Dimension	L=24,0
Material	Stainless steel
Smallest sales unit	1
Unit of quantity	Piece
Weight	1.804 kg
Weight unit	kg/100 pc.

Technical data sheet

Threaded sleeve for heavy-duty frame cassette

Item number: 7406861



Dimensions

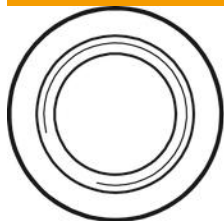

Length	24 mm
Dimension L	24 mm

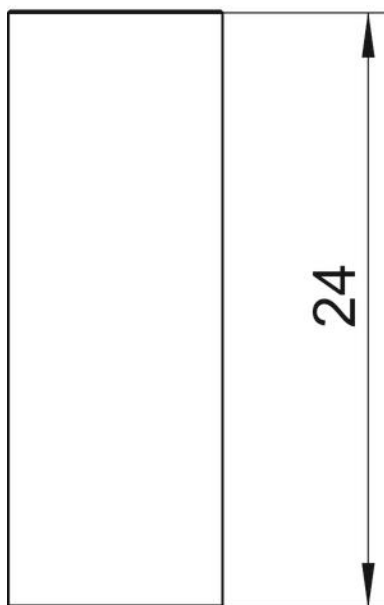

Technical data

Floor covering thickness	24 mm
--------------------------	-------