

Technical data sheet

MS5040P mounting rail, slot 22 mm, perforated, FT

Item number: 1111560



Heavy-duty C profile rail for individual installation of support constructions, e.g. for cable trays or as a panel for switchgear cabinets. Can also be used for cable routing, in conjunction with clamp clips with a U foot.



- St** Steel
- FT** Hot-dip galvanised

Master data

Item number	1111560
Type	MS5040P3000FT
Description 1	Profile rail
Manufacturer	OBO
Dimension	3000x50x40
Material	Steel
Surface	Hot-dip galvanised
Surface standard	DIN EN ISO 1461
Smallest sales unit	3
Unit of quantity	Metre
Weight	255 kg
Weight unit	kg/100 m

Technical data sheet

MS5040P mounting rail, slot 22 mm, perforated, FT

Item number: 1111560



Dimensions

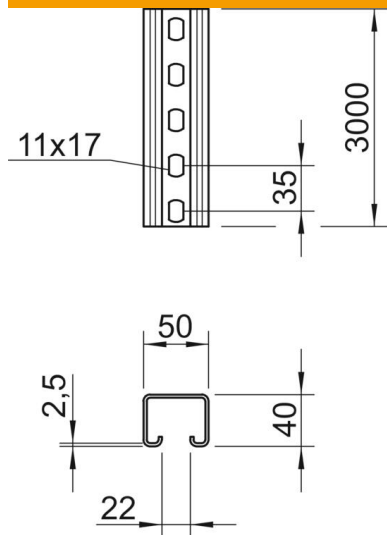

Length	3,000 mm
Width	50 mm
Height	40 mm
Dimension L	3,000 mm

Technical data

Type of perforation	3 sides perforated
Version for	Single profile
Drill hole spacing, centre	35 mm
Hole size	50x40 mm
Material thickness	2.5 mm
Profile shape	C profile
Slot width	22 mm
Static value A	2.88 cm ²
Static value I _y	7.25 cm
Static value I _z	11.04 cm
Static value W _y	2.9 cm ²
Static value W _z	5.25 cm ²